

TM 9-2320-208-20P

(1) ILLUST		(2) SOURCE, MAINT AND RECOVERABILITY CODE				(3) FEDERAL STOCK NO	(4) DESCRIPTION	(5) UNIT OF ISSUE	(6) QTY INC IN UNIT	(7) 15-DAY MAINT ALW PER 100 EQUIP	
(a) FIG NO	(b) ITEM NO	(a) MATERIEL CODE	(b) SOURCE	(c) MAINTENANCE LEVEL	(d) RECOVERABILITY				(a) CO OR BTRY	(b) CO BN OR RECT	
							22 - MISCELLANEOUS BODY, CHASSIS AND ACCESSORY ITEMS - Continued				
							<u>2202 - WINDSHIELD WIPER MOTOR AND RELATED PARTS</u> (Fig. 77)				
77	1		P	O		2540-050-0810	ARM, WINDSHIELD WIPER: adj, olive drab, 7-1/2 closed, 12 extended (M38A1 and M170) (500810)	ea	2		
77	1		P	O		2540-050-0810	ARM, WINDSHIELD WIPER: adj, olive drab, 7-1/2 closed, 12 extended (M38A1C) (500810)	ea	1		
77	2		P	O		2540-050-0814	BLADE, WINDSHIELD WIPER: 10 in. lg (M38A1 and M170) (500814)	ea	2		
77	2		P	O		2540-050-0814	BLADE, WINDSHIELD WIPER: 10 in. lg (M38A1C) (500814) ----	ea	1		
77	3		C	O		2540-040-2596	SPACER: mounting, windshield wiper motor (65909-680787) --	ea	4		
77	4		P	O	R	2540-262-7576	MOTOR, WINDSHIELD WIPER VACUUM: 130 deg throw, w/mounting bolt (M38A1C) (500844)	ea	1		
77	4		P	O	R	2540-262-7576	MOTOR, WINDSHIELD WIPER VACUUM: 130 deg throw, w/mounting bolt (M38A1 and M170) (500844)	ea	2		
77	5		P	O		4720-203-2668	HOSE, RUBBER: air or vacuum lines, low temp 65 deg F, 7/32 in. id, 3/32 in. wall thk (left wiper left line through cowl (18) in. right wiper at tee (1-1/4) in. right wiper right line to cowl (14) in. and tee to wiper and center line (8) in. (4) ft)(33-T-233)	ea	#		
77	6		P	O		4710-350-9897	TUBE, STEEL: cold-drawn, dble wrapped, cop, brazed, 5/16 od, 0.028 in. wall thk (windshield wiper) (27-1/2 in.) (ft) (80244-44-T-5319-65)	ea	#		
77	6		P	O		4710-595-1824	TUBE, STEEL: cold-drawn, dble wrppd, cop, braced, 1/4 od, 0.028 in. wall thk (right windshield wiper (33 in.) left windshield wiper (33 in.) windshield wiper (1-1/2 in.) and windshield wiper vacuum pump to tee (20 in.) (ft) (80244-44-T-5319-60)	ea	#		
							<u>NON-ILLUSTRATED ITEMS</u>				
			P	O		4730-013-7398	NUT INVERTED, TUBE COUPLING: inverted flare, S, cd- or zn-pltd, 5/16 od tu, 0.620 overall lg lines (137398)	ea	2		
			P	O		5305-285-5278	SCREW, ASSEMBLED WASHER: cross-recess-pan-hd, int teeth lockwasher, header-pt, S, cd- or zn-pltd, 1/4-20UNC-2A x 1/2 (454789)	ea	4		
			P	O		4730-014-2432	INVERTED NUT, TUBE COUPLING: inverted flare (142432) --	ea	3		
			P	O		4730-014-2431	INVERTED NUT, TUBE COUPLING: inverted flare (142431) --	ea	2		
			P	O		5310-012-0613	NUT, PLAIN, HEXAGON: S, cd- or zn-pltd, 1/4-28UNF-2B, 7/16w, 5/32 thk (120613)	ea	1		
			P	O		5325-737-1195	GROMMET: rubber, spark plug cable support 11/16 in. hole (65909-301435)	ea	1		

(1) ILLUST		(2) SOURCE, MAINT AND RECOVERABILITY CODE				(3) FEDERAL STOCK NO	(4) DESCRIPTION	(5) UNIT OF ISSUE	(6) QTY INC IN UNIT	(7) 15-DAY MAINT ALW PER 100 EQUIP	
(a) FIG NO	(b) ITEM NO	(a) TECHNICAL SERVICE NO	(b) SOURCE	(c) MAINTENANCE LEVEL	(d) RECOVERABILITY					(a) 3RD ECH (DIR SUP)	(b) 4TH ECH (GEN SUP)
							22 - MISCELLANEOUS BODY, CHASSIS AND ACCESSORY ITEMS - Continued				
							<u>2202 - WINDSHIELD WIPER MOTOR AND RELATED PARTS</u> (Fig. 77) - Continued				
							<u>NON-ILLUSTRATED ITEMS - Continued</u>				
		P	O			5325-700-0997	GROMMET: rubber, windshield wiper hose cowl (65909-800802)	ea	1		
		P	O			5305-285-5278	SCREW, ASSEMBLED WASHER: cross-recess-pan-hd, int, teeth lockwasher (454789)	ea	2		
		P	O			4730-014-2432	NUT, TUBE COUPLING: inverted flared type, 45 deg seat (windshield w/per vacuum pump to tee tube) (142432)	ea	2		

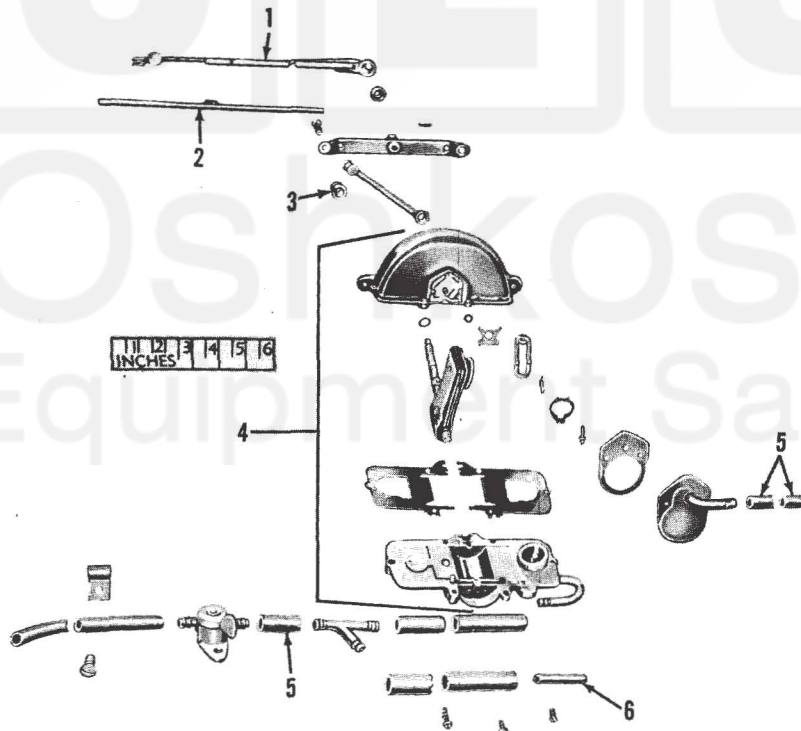

ORD E64921¹

Figure 77. Windshield wiper motor and related parts